

## TORLYS Everest XP

### Designer Plus/Designer/Elite

#### DEAR CUSTOMER,

You have purchased a high quality **TORLYS Everest XP Elite/Designer/Designer Plus** floor, well suited for all residential rooms, including bathrooms\*. Please take a moment to review these installation instructions and plan your installation carefully. Please note that **IMPROPER INSTALLATION CAN VOID WARRANTIES**. Installation of 9 m<sup>2</sup> of flooring, is enough to verify quality and acceptance. Look at boards with sun / light on them. **\*TORLYS Everest XP flooring is not suitable for use in SAUNAS or other abnormal use or conditions including, but not limited to, water damage from plumbing, storms, floods and excessive water saturation on the surface or trapped between subfloor and floor.** If encountering difficulty during installation, STOP and contact **TORLYS Customer Service** at: 07 282 0952 and ask for the Technical Assistance

**Closed-in porches, solariums, screened in gazebos - ALL of these can experience rapid and unbalanced changes in the interior environment that cannot be properly controlled. Installation under these conditions is NOT recommended.**

**IMPORTANT:** Protect flooring from direct sunlight by installing sun filters on windows to minimise fading.

**IMPORTANT:** Before starting the installation, please read carefully this entire document, **paying special attention to (section 6) Completing the Installation.**

#### SET UP

To ensure you have sufficient material on hand, calculate the total area of the room and add 5% of material to allow for custom cutting. Forty-eight hours prior to installation, place the closed packages in the middle of the properly conditioned room (see **Layout** section), **NEVER** against a wall or in a corner, nor near hot or cold air-vents or in direct sunlight. Do not open the packages until you are ready to begin installation.

Flooring is to be stored on a flat floor to prevent distortion. Inspect each plank before installation. If you find any defects, do not use the plank. Contact your supplier immediately.

**Please Note: The TORLYS Warranty does not cover labour for installation of planks with visible defects.**

**IMPORTANT:** Cork is a natural material and therefore no two planks are alike... this adds to its beauty.

**Some variation in grain, colour and shade, as well as knots and mineral streaks, should be expected.** Always work from several boxes at the same time and shuffle planks for the best appearance.

#### PREPARATION

Remove existing carpet, skirtings, trims, quarter-rounds and thresholds. Undercut skirtings, kick boards, door jambs etc using a piece of flooring material with relevant underlay as a height guide. Repair all defects in the subfloor. Additional expansion and contraction space can be achieved by undercutting drywall.

#### **CHECK THAT:**

- The job-site has been cleaned and cleared of debris that could potentially damage the finish of your TORLYS floor.
- The doors can still open and close after installing the floor.
- Doors may have to be cut to supply sufficient clearance.
- The door jambs may need to be adapted to install the floor under them.
- For aesthetic appearance we suggest that you measure the width of the room to ensure that the width of the pieces of the first and last row is approximately the same and not less than 7.5 cm. Cut the width of the pieces of the first and last row as needed.

#### SUBFLOORS

**All subfloors MUST be compliant with current NZ Building code & NZS3604, including the E3/AS1 Amendment, in conjunction with Torlys E3 Alternative Solutions Installation Instructions, if 1.5m from a splash zone, sanitary fixture &/or sanitary appliance.**

Repair any defects in the subfloor. Installation over an uneven subfloor will cause premature damage to floor and make the floor feel unstable. All subfloors must be clean, firm, flat (within 3 mm in 3 m – no variation over 3mm), smooth and dry. The moisture on concrete slabs must be equal or less than 75% Relative Humidity with an *in-situ* probe as per ASTM F2170, 12% or less on plywood or timber based flooring board. You can lay the planks over a solid and stable subfloor material that meets these requirements.

It is essential that the crawl space under subfloors is sufficiently ventilated. Remove any obstacles and provide sufficient ventilation. A 6 mil (0.15 mm) poly vapour barrier must be installed on crawl space underfloor to eliminate moisture rising\*

*\* In construction terminology, a crawl space is defined as: "a shallow space below the living quarters of a house, normally enclosed by the foundation wall..."*

#### LAYOUT

The floor should be installed from several cartons at the same time to ensure colour and shade mix. If possible, lay the planks parallel to window light.

**The ideal environment is a temperature of 16 °C – 21 °C and relative humidity of 40 - 60%.**

The floor will be stronger and more stable if the joints are staggered at least 20 cm in each row.

Staggered or irregular joints result in less waste and enhance the overall appearance of the floor. Do not stair step the flooring across the room.

All skirtings, mouldings, door frames, etc., should be undercut to allow an expansion and contraction space around the **entire perimeter of the floor**. Be sure to leave the minimum 13 mm expansion and contraction space on all sides of the floor, around pipes, thresholds, under doors and around any fixed objects (floor vents, kitchen cabinets/islands, etc.).

**Kitchen cabinets/islands should not sit on the flooring** as this will prevent natural expansion and contraction due to climate fluctuations. Any wedges should be removed, after the flooring installation has been completed, to be covered by skirtings and/or drywall (if wall is undercut).

**NOTE:** Never hit the planks directly with your hammer or rubber mallet. Always use a **TORLYS Tapping Block or TORLYS Bulldog™ tool\*\*** to protect the edges of the planks. Make sure the Tapping Block is in good condition. Hold Tapping Block down when using it.

## TOOLS

- Hammer (1 lb.)
- Tape Measure
- Pencil
- Saw, utility knife
- Tapping Block\*
- Last-Board Puller\*
- 10 mm Wedges\*
- Mask (3M™ Tekk Protection™ Sanding and Fibreglass Disposable Respirator, 8200HB5-A), or equivalent.



When sawing pieces off the planks, use a fine-toothed hand saw, jigsaw, chop-saw or guillotine.

**\*Note:** available in a TORLYS Installation Kit

**\*\*OPTIONAL:** for ease of installation and repairs use TORLYS Bulldog™ tool.

## FLOATING METHOD

Prepare the subfloor. **TORLYS Everest XP** has a built-in cork backing and therefore only Torlys Polythene Underlay is required.

When installing **TORLYS Everest XP** over cementitious subfloors, first cover the subfloor with 6 mil (0.15 mm) poly vapour barrier, overlap edges by 30 cm, damp-proof tape the seams and run up 6 cm on each wall if skirtings are off.

**The use of a 6 mil (0.15 mm) poly vapour barrier is mandatory** for all floating installations over all cementitious subfloors, this also helps the floor to slide when installing or if a repair was required.

**DO NOT USE GLUE.**

## PREVENTATIVE MAINTENANCE

To ensure the full benefit of your **TORLYS Everest XP** floor and to extend its beauty for years to come, we recommend the following preventative maintenance suggestions:

- **Install floor protectors** on furniture legs to protect against scratches and dents. These furniture pads should have no wrinkles and be made of soft, non-staining material (e.g. felt pads); the felt pads should be of adequate size to support the weight of the furniture and a minimum of 2.5 cm in diameter. The floor protectors should sit flat on the floor and be inspected periodically for cleanliness and wear. For heavy pieces of furniture (e.g. couches) the use of coaster-cups is recommended. Chair mats for hard-surface floors are also recommended.

- **DO NOT DRAG FURNITURE** or other heavy objects on the floor. Avoid high heels or shoes that need repair. Some types of high heel shoes can severely damage the surface of any floor covering. For minor scratch repairs, a touch-up kit is available at your TORLYS Dealer. For damages that require plank replacement, the TORLYS Bulldog™ tool, is available through your dealer.

- **Install sun filters or close your curtains or blinds** where continuous or extreme sunlight will shine on your floor. Also UV protection in windows will help with the performance of your furnishings. A combination of heat and sunlight can cause most furnishings and flooring to fade or change colour.
- **Sweep and vacuum floor regularly.** Use correct hard surface vacuum tools. **DO NOT** use rotating heads, floor scrubbers, steamers, jet mops, buffers or similar products.
- **Wipe up spills immediately.** DO NOT allow topical moisture to remain on the floor longer than the time specified in the product warranty.
- **Avoid sand and grit build up.** At doorways and areas of heavy wear, use protective mats or rugs that are marked “non-staining”.

For dry maintenance, use a dust mop, vacuum cleaner or dry cloth. For damp maintenance, use the TORLYS EcoCare Cleaning Kit, available from your Authorized Dealer, and follow the maintenance instructions on the container.

**Torlys floor cleaner MUST be used to maintain product warranty.**

Never wax or use oil-based products on your **TORLYS Everest XP** Floor.

Spot cleaning is with a clean damp cloth with no chemical residue.

**IMPORTANT: To keep your warranty valid, use TORLYS recommended maintenance products and follow TORLYS maintenance instructions. For more information on maintenance products and instructions go to: [www.torlys.co.nz](http://www.torlys.co.nz)**

**Maintain the humidity level at 40 – 60%.** Certain regions have extreme changes in humidity levels, which may affect all natural floors. To maintain humidity within a healthy range, a humidifier or dehumidifier may be required. Gapping can occur in natural floors with seasonal fluctuations and when in extremely dry conditions (Low R.H.).

# INSTALLATION INSTRUCTIONS

## 1) GENERAL

TORLYS Uniclic® & Unifit-X® is a revolutionary system for installing floating floors without glue. Instead, it uses an ingenious tongue and groove system to “lock” the planks together. **TORLYS Everest XP Elite/Designer/Designer Plus** incorporates Unifit X® on the end joint to allow for drop down, angling or tapping installation. The length joint is the standard Uniclic® joint and is compatible with Unifit X®.



**IMPORTANT:** Use a hammer and the special TORLYS Tapping Block positioned as shown in diagram (right) or TORLYS Bulldog™ tool. Never use any other tapping block, as it may damage the planks.

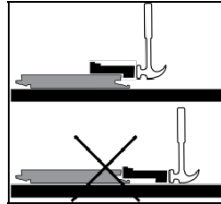

For a short edge, you can angle the plank into place, for example in the first row. Or you can drop down the joint to click it into place. Where you cannot angle or drop down the joint, you can engage it horizontally using a tapping block or Bulldog Tool. If tapping, use several small taps until the planks click together completely.

For a long edge, angle-click the plank into place. If you cannot angle-click the planks (e.g. when installing final row), tap planks together gradually. Begin tapping lightly at the corner of a plank until the joint has clicked together.

Repeat the process approximately every 30 cm until the entire long edge of the plank has clicked in with the next plank. Use a **TORLYS “Last-Board Puller” or Bulldog™ tool** to pull exposed joints tight, where a tapping block and hammer will not fit. **Never attempt to knock the joint into place with one hit.** For the best results, follow the installation instructions and use only:

- A) **TORLYS INSTALLATION KIT**  
(Wedges, TORLYS tapping block and last-board puller)
- B) **TORLYS MAINTENANCE PRODUCTS**  
[TORLYS EcoCare (pH Neutral) Cleaner]
- C) **TORLYS BULLDOG™ TOOL**
- D) **6 MIL (0.15 MM) POLY VAPOUR BARRIER UNDER ALL FLOORS**

## 2) CORRECT INSTALLATION

Ensure your floor substrate is compliant with NZ Building Code ES/AS1 wet area requirements.

Wood and cork are the primary components of your **TORLYS Everest XP** flooring. Since the humidity of a room can vary from one season to the next, the floor must be able to expand and contract in **ALL** directions. **A minimum of 13 mm expansion/contraction space** must be provided at all walls and vertical obstructions (e.g. around pipes and at thresholds). These gaps may be covered by a skirting that is not fixed to the cork floor, but to the wall. Install the planks in the same direction as the longest wall, or the same

direction in which the light falls, for a more appealing look. Begin installing the floor from the right corner of the room.

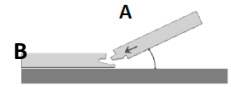

Always remember that the easiest way to install the floor is by placing the tongue (A) into the groove (B).

Lift plank being installed to 20 - 30 degree angle and keep tongue of the plank in the groove of installed plank. With gentle pressure and a gentle rocking motion, push the plank down. If necessary, finish locking the plank with a tap into place using a tapping block or Bulldog tool.

## TRANSITION MOULDINGS

Installation cannot exceed 15 m in any direction without installing a transition moulding (e.g. T-Moulding). Transition mouldings are also required in doorways.

### MATCH TRANSITION MOULDINGS (e.g. Smart Trims)

For the best appearance compare the transition mouldings and flooring before installation, identify the pieces that best match the mouldings for colour and grain, set them aside and then install them as needed.

Note: If using flush-mount stair nosing in conjunction with this flooring, do not commence installation before referring to the stair nosing instructions. For details go to [www.torlys.co.nz](http://www.torlys.co.nz) Smart-step installation instructions.

## 3) THE FIRST ROWS

Saw off the tongue of the first plank, both on the short as well as the long edge. For all other first-row planks cut off the tongue on the long edge (**Photo I**). Orient the first plank in the right corner of the room.

Maintain a minimum spacing of (I) 13 mm, using wedges. Lay the planks with the tongue side (II) facing the wall in order to use the tongue/groove system. Lay the first row along the wall [note that an expansion space of a minimum 13 mm must be provided at the wall, as well as at all columns, (II) heating pipes, doorframes, etc.].

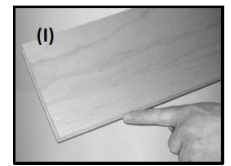

### IMPORTANT

Turn the plank inclined with the end joint into the already laid plank. Click the two together. Ensure that the planks of the first row are straight (III). The cut piece from the first row becomes the starting piece for another row. Install the cut edge facing the wall, with the expansion wedge in place. Now angle this piece and click it into the first plank of the first row. The cut pieces should be a minimum of 20 cm in length (III). Continue the second row with a full piece, placing the tongue of the long side into the groove of first row piece (IV).

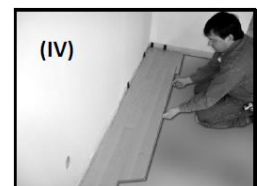
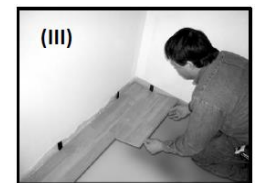

Move the end joints together until they are approximately 6 mm apart. Click the plank lengthwise into place. For the short edge, use the tapping block and a number of smaller taps until the planks click into place completely.

Do not attempt to knock the joint into place with one hit. Continue this method for each plank, covering the entire width of the room.

PLEASE NOTE: that the stagger between the head joints should be 20 cm minimum, and preferably 30 cm. Cut the last planks of each row leaving a minimum 13 mm gap to the wall.

#### 4) THE FINAL ROW

Measure and cut the planks of the final row so that there is a minimum 13 mm expansion/contraction space between the final row and the wall. These planks will be tapped into the last row using the **Last-Board Puller or TORLYS Bulldog™ tool**. Knock short edges together using TORLYS Tapping Block.

#### 5) UNDER DOOR FRAMES

Saw the planks so that after installation there is a minimum **13 mm** expansion/contraction space. This expansion/contraction space can be covered by undercutting the door jamb. If you cannot rotate this plank, use the TORLYS Tapping Block and hammer to tap the planks together.

TORLYS has designed a special tool for this type of installation: the TORLYS Bulldog™ tool.

#### 6) COMPLETING THE INSTALLATION – Required for WATER SURFACE WARRANTY\*

After installing your floor, you can immediately walk on it and begin the final touches. This is one of the major benefits of the glue-less system.

Remove any spacer wedges to create a water-resistant surface.

#### BEST PRACTICE:

##### Install with skirtings off:

First fill all expansion spaces with suitably sized, compression fitted, compressible PE foam backer rod (*NZ Building Code Compliant*).

Next, create a watertight seal by applying a continuous bead of waterproof, flexible, 100% silicone sealant on top of the foam backer rod, around perimeter of room and within 1.5 m of any sanitary item. Covering at least 3mm of the floor and 3mm running up the wall (which will then be covered by the skirting).

##### If undercutting:

If possible – use a Compressible PE Foam Backer Rod, suitably sized, (compression fitted), continuously under skirtings prior to installing the flooring.

If this isn't possible, there **MUST be a MINIMUM 5mm continuous bead** of waterproof, flexible, 100% silicone sealant around the entire perimeter of the room, within 1.5m of any sanitary fixture, sanitary appliance &/or splash zone, sealing the gap between floor and skirting.

This includes the junction between skirtings / toe-kicks / cabinetry and flooring, preferably around the entire perimeter of the room.

**Prior to installing the trim mouldings**, first fasten the track to the subfloor, then apply the flexible silicone sealant along the portion of the moulding that will contact directly timber veneer surface.

Install mouldings and immediately wipe away any excess silicone sealant.

Apply the specified flexible silicone sealant to door frames and trims, or any other fixed objects.

Please see drawings below.

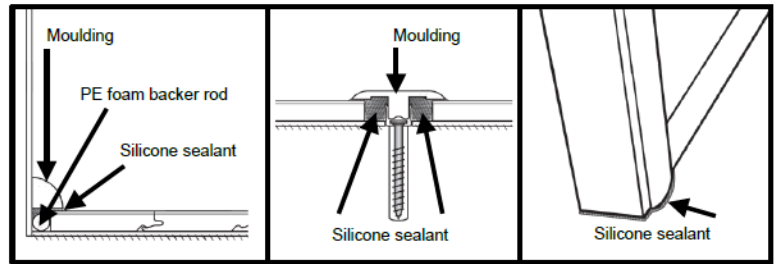

\*For areas required under legislations such as NZBC or **non-water warranty** areas of installation, PE foam backer rod and silicone sealant are not required.

**IN BATHROOMS:** the use of flexible, waterproof antimould silicone to seal the expansion and contraction space is **mandatory**.

#### 7) RADIANT HEAT APPLICATION

TORLYS Everest XP is guaranteed for installation over radiant-heated subfloors.

The underfloor heating components / wires must be covered in a screed.

**Ensure you check with your radiant heat technician also.**

For details and limitations, please check the [\*“TORLYS Flooring Warranty and Instructions for installation over radiant-heated subfloors”\*](#).

Visit our website at: [www.torlys.co.nz](http://www.torlys.co.nz) for detailed information.

##### **ATTN: INSTALLERS – CAUTION: Wood Dust**

Sawing, sanding and machining wood products can produce wood dust. Airborne wood dust can cause respiratory, skin and eye irritation. The International Agency for Research on Cancer (IARC) has classified wood dust as a nasal carcinogen in humans.

**Precautionary Measures:** Power tools should be equipped with a dust collector. If high dust levels are encountered use an approved dust mask. Avoid dust contact with skin and eyes.

**IF YOU HAVE ANY QUESTIONS, PLEASE CALL**

**07 282 0952**

**Head Office NZ: TORLYS NZ.**

11 Brent Greig Lane, Burbush, Hamilton 3200

**[www.torlys.co.nz](http://www.torlys.co.nz)**